

■ Fault symptom

The customer complained that the engine temperature was above normal.

■ Fault diagnosis process

1. Confirmed the problem.

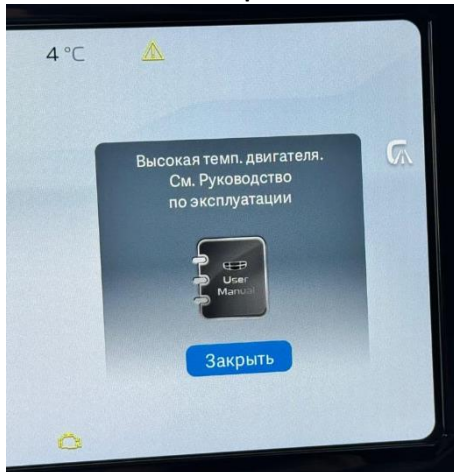

2. Used GLDS to check DTC, found ECM-P021700 Engine Coolant Overtemperature Condition.

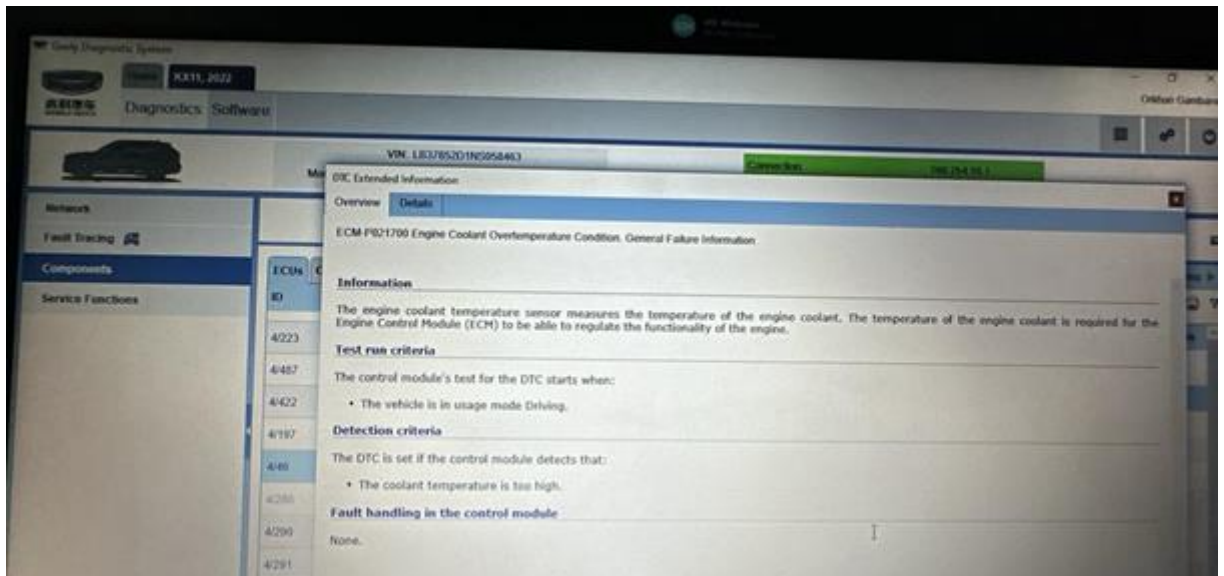

3. Checked the data of water pump, and found the speed changing in strange way, 3500-5900 r/min.

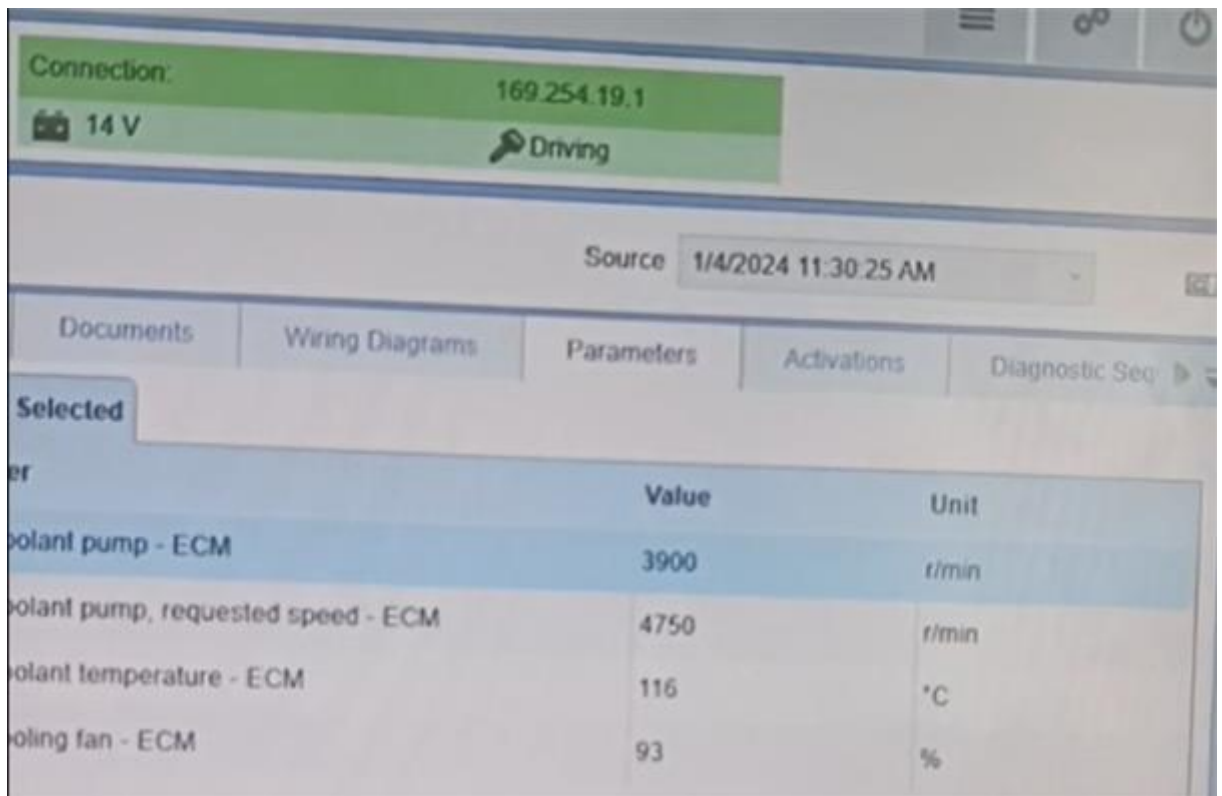

4. Maybe some problem with the pump, then checked the fan of water pump, it was stuck.

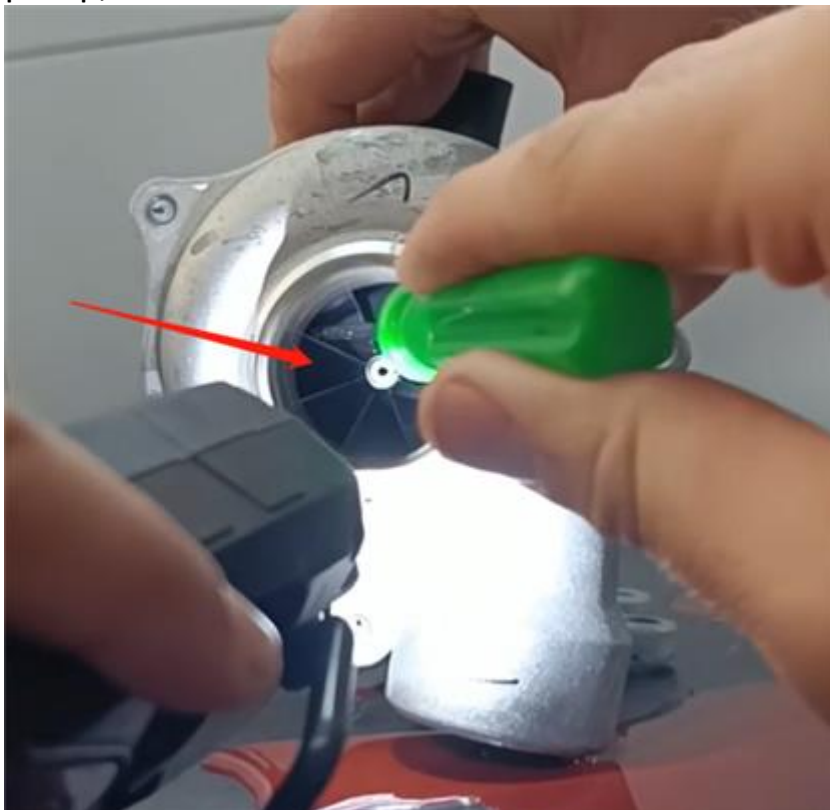

■ Fault solution

Replace the water pump.

■ **Quality inspection & repair confirmation**

Recheck and confirm the fault is solved.